

# T ECHNICAL INFORMATION



2010-13

**Subject** Optimisation of ignition system

**For model**

PS-460, PS-460 D, PS-4600 S, PS-4600 SH, PS-4605, PS-4605 H, PS-500, PS-500 C, PS-500 D, PS-510, PS-5000, PS-5000 D, PS-5000 H, PS-5000 HD, PS-5100 S, PS-5100 SH, PS-5105, PS-5105 C, PS-5105 CH, PS-5105 CX, PS-5105 H, PS-5105 D, PS-5105 H, PS-5105 HD

**Country**

World wide

**Description**

In relation to continuous product improvement ignition coil and crank shaft have been modified to enhance starting behaviour. Single spare parts of the different systems are not interchangeable. The system of crank shaft and ignition are replaceable only as a set. New ignition cut off has been set to 13.800 rpm for all models!

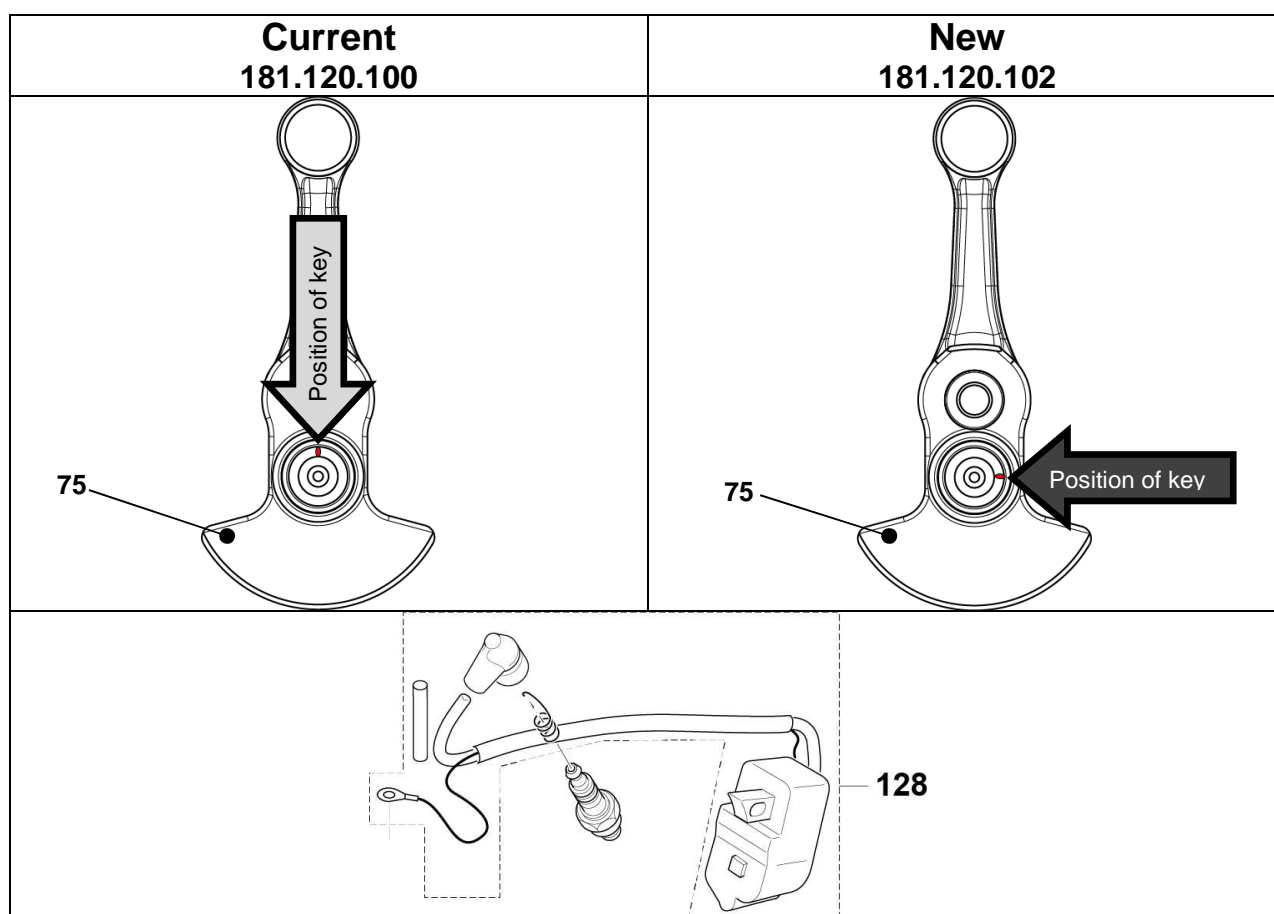

Pos.	Old part	Description	I/C	New part	Description	Note
75	181.120.100	Crank shaft cpl.	No	181.120.102	Crank shaft cpl.	
128	181.143.110	Ignition coil cpl., <b>grey</b>	No	181.143.212	Ignition coil cpl., <b>black</b>	Professional type (short high tension lead, insulating hose: <b>green</b> )
128	181.143.210	Ignition coil cpl., <b>red</b>				
128	181.143.204	Ignition coil cpl., <b>red</b>	No	181.143.206	Ignition coil cpl., <b>black</b>	Farmer type (long high tension lead, insulating hose: <b>black</b> )

To assure replacement of correct ignition, please find following an overview containing the colour combination of ignitions. In case of need for replacement please make sure to order right part.

## Procedure:

Unscrew the spark plug, turn crankshaft in upper dead point, unscrew the nut of the flywheel, identify crankshaft according to the drawings above, check type and find the corresponding ignition. Retighten flywheel nut with 25+-1 Nm.

If the original ignition was still mounted, each built-in -ignition can be identified by the colour combination. The possible ignitions are shown, the current ignition bold.

	Part number	DOLMAR	Colour housing	Colour ignition cable	Colour insulation tube	Replaced by	Note
Crankshaft 181.120.100	Ignition 181.143.101	PS-4600 S, PS-5100	grey	grey	red	Ignition 181.143.103	Interchangeable
	Ignition 181.143.103	PS-4600, PS-5100	grey	black	red	Ignition 181.143.203	
	Ignition 181.143.201	PS-460, PS-500, PS-510, PS-5000	red	grey	red	Ignition 181.143.203	
	Ignition 181.143.203		red	black	red	Ignition 181.143.204	
	<b>Ignition 181.143.204</b>	<b>PS-460, PS-4600, PS-500, PS-510, PS-5000, PS-5100</b>	<b>red</b>	<b>black</b>	<b>black</b>		
	Ignition 181.143.110	PS-5105	grey	black	green	Ignition 181.143.210	Interchangeable
	<b>Ignition 181.143.210</b>	<b>PS-4605, PS-5105</b>	<b>red</b>	<b>black</b>	<b>green</b>		
Crankshaft 181.120.102	Ignition 181.143.205	PS-460, PS-500, PS-510	black	black	black	Ignition 181.143.206	Interchangeable
	<b>Ignition 181.143.206</b>	<b>PS-460, PS-500, PS-510</b>	<b>black</b>	<b>black</b>	<b>black</b>		
	Ignition 181.143.211	PS-4605, PS-5105	black	black	green	Ignition 181.143.212	Interchangeable
	<b>Ignition 181.143.212</b>	<b>PS-4605, PS-5105</b>	<b>black</b>	<b>black</b>	<b>green</b>		

## Implementation

Into serial production as from March 2010.  
As a spare part with immediate effect.