

REMINGTON CHAIN SAW
Illustrated Parts List

Issued: NOV 73
Revised:

STARTING WITH
SERIAL TL2523

MIGHTY MITE AUTOMATIC = MMA

MIGHTY MITE BANTAM = MMB

MIGHTY MITE DELUXE = MMD

IMPORTANT

DO NOT USE KEY NUMBERS WHEN ORDERING SERVICE PARTS.

ALWAYS ORDER COMPONENTS BY PART NUMBER AND PART NAME.
INCLUDE MODEL AND SERIAL NUMBER.

Key NO.	Part NO.	Description	QTY
1	66291	BAFFLE, Muffler, (MMA & MMD)	1
2	66236	BEARING, Sprocket	1
3	67822	BEARING, Thrust	2
4	66285	BELLOWS, Pump, Oil	1
5	64327	BELLOWS, Link, Oil	1
		Link, Throttle	1
6	66256	BLOCKING, Adjusting, (MMA & MMD)	1
7	66227	BODY, Muffler	1
8	66242	BRACKET, Carburetor	1
9	68034	BREAKER PKG	1
10	67976	BUTTON, Throttle, Latch, (MMA)	1
11	67962R	CAP ASSY, Fuel, Includes:	1
-1	66736	RING, "O"	1
12	68066	CAP, Oil, (MMB)	1
12	68074	CAP ASSY, Oil, (MMA & MMD) Includes:	1
-1	66737	RING, "O"	1
13	66182	CARBURETOR, Includes:	1
-1	66770*	DIAPHRAGM, Main	1
-2	66771*	DIAPHRAGM, Pump	1
-3	66772	GASKET, Diaphragm	1
-4	66773	GASKET, Pump	1
-5	64465	NEEDLE, Inlet	1
-6	67368*	PLUG, Welch	1
-7	66775	SCREW, Mixture, "LO" Speed	1
-8	66921*	GASKET SET	1
-9	66922	REPAIR KIT	1
14	66218	CLUTCH ASSY, Includes:	1
-1	66787	PLATE, Drive	1
-2	66788	SHOE, Friction (Set of 2)	1
-3	66789	SPRING, Clutch	2
15	68039	COVER ASSY, Crankcase, Includes:	1
-1	66232	BEARING, Roller	1
-2	66231	SEAL, Oil	1
16	68025	COIL ASSY, Includes:	1
-1	60030	COVER	1
-2	60029	SPRING	1
17	66207R	COVER, Carburetor	1
18	66754	COVER, Clutch	1
19	66206C	COVER, Handle, Rear, (MMB & MMD)	1
19	66802C	COVER, Handle, Rear, (MMA)	1
20	66228	COVER, Muffler	1
21	66208	COVER, Sprocket	1

Key NO.	Part NO.	Description	QTY
22	66769	COVER ASSY, Tank, Oil, (MMB), Includes:	1
-1	66293	PLUNGER, Pump, Oil	1
-2	38684	RING, "O", Pump, Oil	1
-3	66753	RING, Retaining	1
-4	66264	SPRING, Pump, Oil	1
22	66274	COVER ASSY, Tank, Oil, (MMA & MMD), Includes:	1
-1	66443	NEEDLE, Adjusting, Oil	1
-2	66293	PLUNGER, Pump, Oil	1
-3	64682	RING, "O", Needle, Adjusting	1
-4	38684	RING, "O", Pump, Oil	1
-5	66753	RING, Retaining	1
-6	66264	SPRING, Pump, Oil	1
23	66767	CRANKCASE ASSY, (MMB), Includes:	1
-1	66232	BEARING, Roller	1
-2	66231	SEAL, Oil	1
-3		NOT USED	
23	68156	CRANKCASE ASSY, (MMA), Includes:	1
-1	66232	BEARING, Roller	1
-2	66231	SEAL, Oil	1
-3	65609	VALVE, Check	1
23	66272	CRANKCASE ASSY, (MMD), Includes:	1
-1	66232	BEARING, Roller	1
-2	66231	SEAL, Oil	1
-3	65609	VALVE, Check	1
24	68037	CRANKSHAFT	1
25	66201	CYLINDER, (MMD)	1
25	66768	CYLINDER, (MMB & MMA)	1
26	68029	FAN	1
27	66241	FILTER, Air	1
28	66944	FILTER ASSY, Pickup, Fuel, Includes:	1
-1	67016	FILTER, Fuel, Felt	1
29	67590	FILTER, Pickup, Oil, (MMB)	1
29	66267	FILTER, Pickup, Oil, (MMA & MMD)	1
30	66251	GASKET, Crankcase	1
31	66252	GASKET, Cylinder	1
32	66255	GASKET, Tank, Oil	1
33	66911	GASKET, Tank, Oil, Cover	1
34	68454	GRIP, Handle, Rear	1
35	68181	GROMMET, Carburetor	1
36	62845	GROMMET, Choke	1
		Release, Compression, (MMD)	1

*Parts included in REPAIR KIT #66922

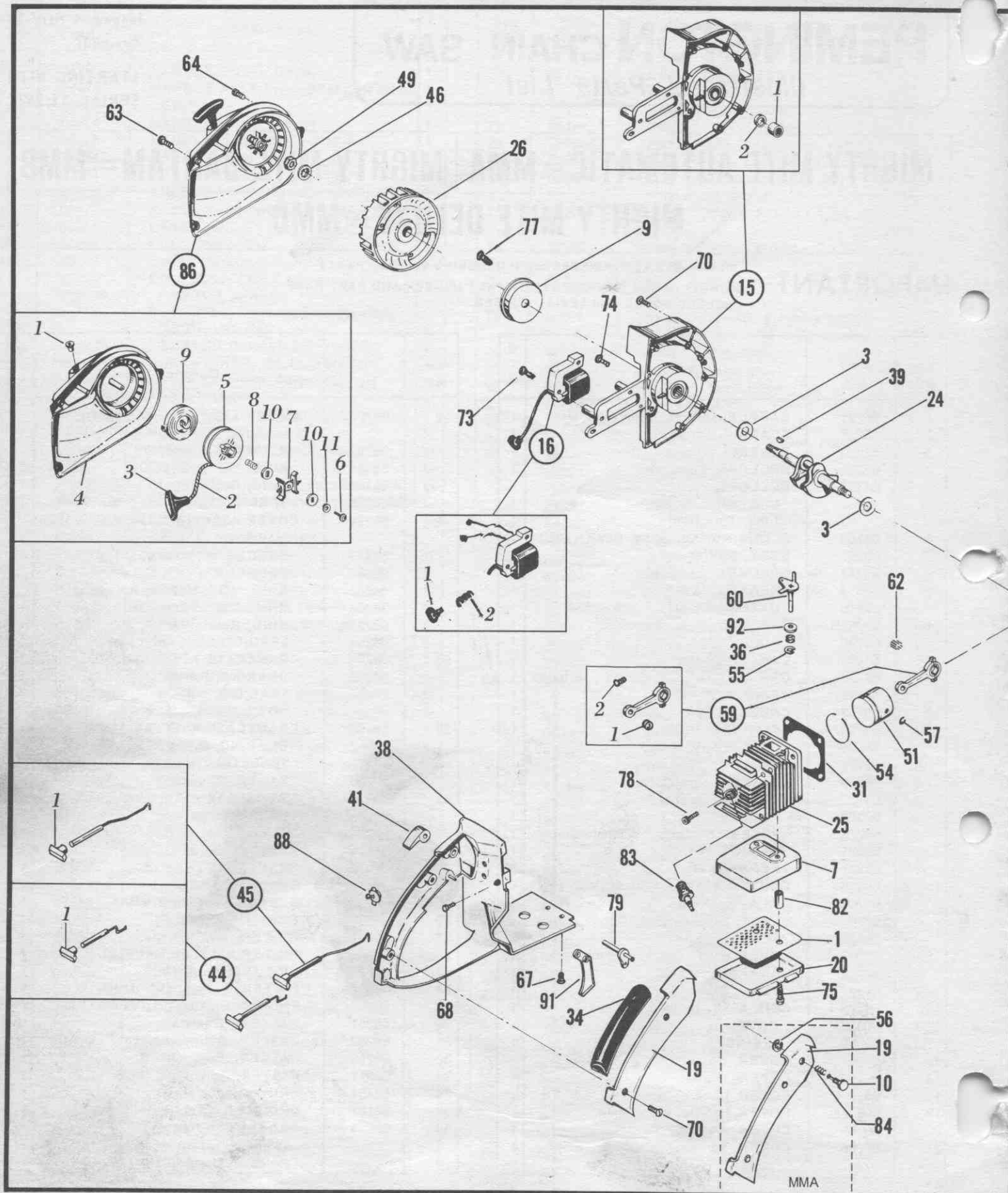

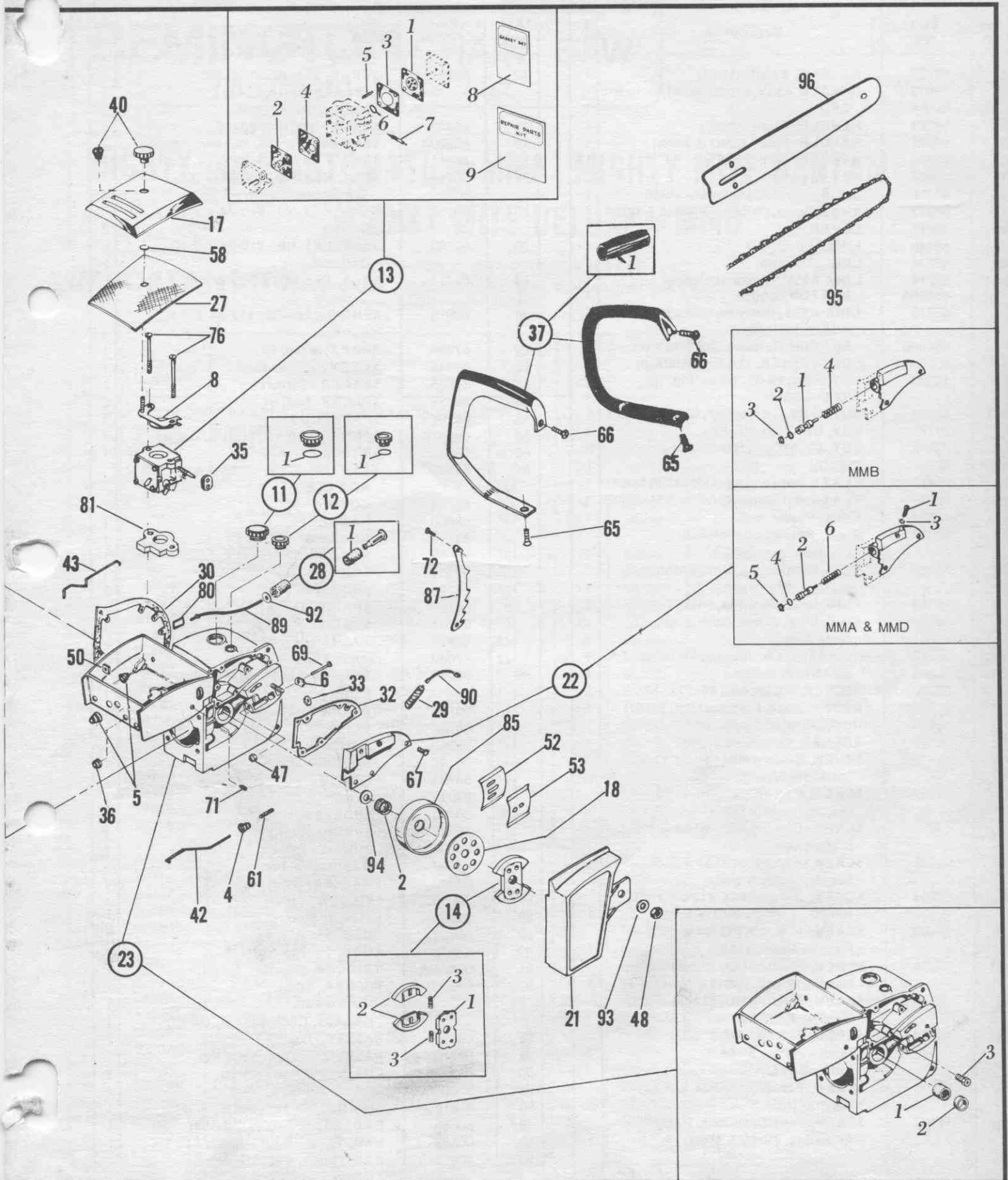

SAW CHAIN & GUIDE BAR FOR MIGHTY MITES

SAW CHAIN					
		HARD NOSE		ROLLER NOSE	
MODEL	Capacity	Catalog NO.	Part NO.	Catalog NO.	Part NO.
MMB	10"	20PF56	91321D		
MMA & MMD	12"	20PF64	91000D		
	14"	20PF72	91312D	20PF74	91314D
GUIDE BAR					
		HARD NOSE		ROLLER NOSE	
MODEL	Capacity	Catalog NO.	Part NO.	Catalog NO.	Part NO.
MMB	10"	S4008N	90688		
MMA & MMD	12"	M4010N	90682		
	14"	M4012N	90670	M1012N	90671

ACCESSORIES FOR MIGHTY MITES

Part NO.	Description
67572	CASE, Carrying
13688	FILE, Flat
66478	FILE, Round
66488	GUIDE, Holder, File
14207	HANDLE, File
18347	LUBRICANT, Nose, Roller
48411	OIL, Engine
66505	SET, Gauge
66945	WEDGE, 5"
66976	WRENCH, HEX, .50 & Screwdriver
64927	WRENCH, Sparkplug, .75"

Key NO.	Part NO.	Description	QTY
37	67750	HANDLE, Front, (MMB)	1
37	68073	HANDLE ASSY, Front, (MMA), Includes:	1
-1	66035	GRIP	1
37	66284	HANDLE, Front, (MMD)	1
38	66275	HANDLE, Rear, (MMD & MMA)	1
38	66804	HANDLE, Rear, (MMD)	1
39	104364	KEY, Woodruff	1
40	68065	KNOB, Cover, Carburetor, (MMB)	1
40	67477	KNOB, Cover, Carburetor, (MMA & MMD)	1
41	66211	LEVER, Oil	1
42	66248	LINK, Pump, Oil	1
43	66246	LINK, Throttle	1
44	66714	LINK ASSY, Choke, Includes:	1
-1	66680A	BUTTON, Choke	1
45	66715	LINK ASSY, Release, Compression, (MMD), Includes:	1
-1	66680B	BUTTON, Release, Compression	1
46	103268	LOCKWASHER, .31, Cup, Starter	1
47	118330	NUT, HEX, #8-32, Adjusting, (MMA & MMD)	1
48	66258	NUT, HEX, .25-28, Bar, Guide	1
49	103141	NUT, HEX, .31-24, Fan	1
50	103046	NUT, SQ, #10-24, Handle, Rear	2
51	67837	PISTON	1
52	66238	PLATE, Bar, Guide, Inside, (MMA & MMD)	1
53	66239	PLATE, Bar, Guide, Outside, (MMA & MMD)	1
54	67826	RING, Piston	1
55	66757	RING, Retaining, Release, Compression, (MMD)	1
56	65089	RING, Retaining, Latch, Throttle, (MMA)	1
57	65058	RING, Retaining, Pin, Piston	2
58	66738	RING, Snap, Cover, Carburetor, (MMA & MMD)	1
59	66277	ROD ASSY, Connecting, Includes:	1
-1	66235	BEARING, Roller	1
-2	66280	SCREW, Socket HD, #6-40 x .44	2
60	66287	ROD, Release, Compression, (MMD)	1
61	66296	ROD, Plunger, Pump, Oil	1
62	65020D	ROLLER, Strip, (Set of 26)	1
63	67979	SCREW, Binding-HD, #10-24 x .75, Starter, (MMB)	2
63	66907	SCREW, Flat-HD, #10-24 x .75, Starter, (MMA & MMD)	2
64	67980	SCREW, Binding-HD, #10-24 x 1.12, Starter, (MMB)	1
64	66908	SCREW, Flat-HD, #10-24 x 1.12, Starter, (MMA & MMD)	1
65	67764	SCREW, Binding-HD, #12-24 x .56, Handle, Front, (MMB & MMA)	1
65	66909	SCREW, Flat-HD, #12-24 x .56, Handle, Front, (MMD)	1
66	67765	SCREW, Binding-HD, #12-24 x .75, Handle, Front, (MMB & MMA)	1
66	66910	SCREW, Binding-HD, #12-24 x .75, Handle, Front, (MMD)	1
67	66724	SCREW, Flat-HD, #6 x .38, Handle, Rear Tank, Oil, Cover	2 4
68	66906	SCREW, Flat-HD, #10-24 x .62, Handle, Rear	2
69	101114C	SCREW, Fil-HD, #8-32 x 1.75, Adjusting, (MMA & MMD)	1

Key NO.	Part NO.	Description	QTY
70	66721	SCREW, Fil-HD, #6 x .62, Crankcase, Cover	7
		Handle, Rear, Cover	2
71	66442	SCREW, "IDLE", Speed	1
72	63960A	SEMS, #8-32 x .38, Sticker, (MMD)	2
73	66851	SEMS, Fil-HD, #8-32 x .75, Coil	2
74	66260	SEMS, HEX-HD, #10-24 x .62, Crankcase, Cover	4
75	66262	SEMS, HEX-HD, #10-24 x 1.12, Muffler	2
76	66263	SEMS, HEX-HD, #10-24 x 2.12, Carburetor	2
77	65217	SEMS, Pan-HD, #6-32 x .31, Breaker	2
78	66918	SEMS, Socket-HD, #12-24 x 2.12, Cylinder	4
79	67969	SHAFT, Pump, Oil	1
80	67349	SLEEVE, Line, Fuel	1
81	67985	SPACER, Carburetor	1
82	66438	SPACER, Muffler	2
83	65292	SPARKPLUG	1
84	64367A	SPRING, Latch, Throttle, (MMA)	1
85	93032	SPROCKET, A29-258	1
86	68061C	STARTER ASSY, (MMB), Includes:	1
		NOT USED	
-1		CORD	1
-2	66792	CORD	1
-3	68060	HANDLE	1
-4	68199C	HOUSING	1
-5	68059	ROTOR	1
-6	67039	SEMS	1
-7	66795	SHOE, Friction	1
-8	66796	SPRING, Brake	1
-9	66797	SPRING, Rewind	1
-10	66798	WASHER, Fiber	2
-11	67040	WASHER, Steel	1
86	66219	STARTER ASSY, (MMA & MMD), Includes:	1
-1	66799**	BUSHING, Starter	1
-2	66792	CORD	1
-3	68060	HANDLE	1
-4	66791	HOUSING	1
-5	66794	ROTOR	1
-6	67039	SEMS	1
-7	66795	SHOE, Friction	1
-8	66796	SPRING, Brake	1
-9	66797	SPRING, Rewind	1
-10	66798	WASHER, Fiber	2
-11	67040	WASHER, Steel	1
87	66669	STICKER, (MMD)	1
88	66668	SWITCH, Stop	1
89	66224	TUBE, Pickup, Fuel	1
90	67972	TUBE, Pickup, Oil	1
91	66223R	TRIGGER, Control, Throttle	1
92	103606	WASHER, Steel, Fuel, Filter Release, Compression, (MMD)	1
93	66257	WASHER, Bar, Guide	1
94	67770	WASHER, Thrust, Sprocket	1
95	91321D	CHAIN, 20PF56, (MMB)	1
95	91000D	CHAIN, 20PF64, (MMA)	1
95	91312D	CHAIN, 20PF72, (MMD)	1
96	90688	BAR, Guide, S4008N, (MMB)	1
96	90643	BAR, Guide, M4010N, (MMA)	1
96	90670	BAR, Guide, M4012N, (MMD)	1

**Part Included in HOUSING #66791